

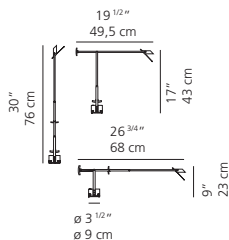

Concept Design | Styling and Photo: [industrialista](#), [studioindustrialista](#), Montreal | Artwork: Joseph Bangsund

- Table standing luminaire for adjustable direct lighting
- Fully adjustable, balanced electrical conductor arms in aluminum
- Arm spacer bars in chromed steel with red molded thermoplastic insulators
- Counter weights in die-cast zinc
- Adjustable head in die-cast aluminum with inner high efficiency reflector in anodized aluminum, with U.V. bulb protective glass lens
- 360° rotatable base in die-cast aluminum with incorporated low voltage transformer and two intensity on/off switch
- **c.U.L.us listed** for Tizio classic and micro



Tizio micro

finish



light source

HAL G4 20W/12V

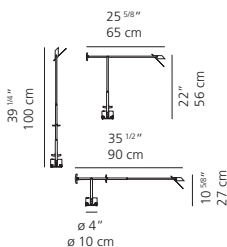

Tizio 35

finish



light source

HAL GY6.35 35W/12V

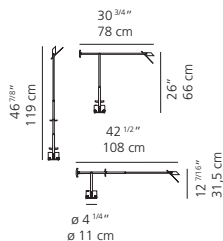

Tizio classic

finish



light source

HAL GY6.35 50W/12V